

DOMETIC

AWNINGS

POWER AWNING

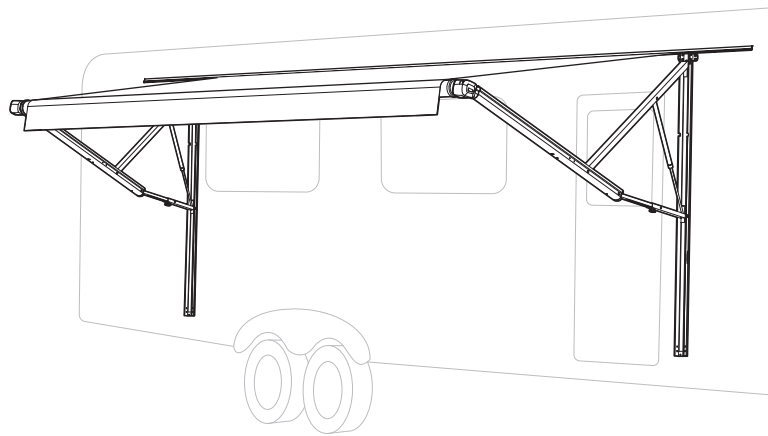

9200 Model

EN

9200 Series Power Awning

Installation Instructions

NORTH AMERICAN ADDRESS INFORMATION

USA & CANADA

Service Office
Dometic Corporation
1120 North Main Street
Elkhart, IN 46514

Service Center & Dealer Locations

Visit: www.dometic.com

Form No. 3316600.000_A 7/18 | ©2018 Dometic Corporation

Read these instructions carefully. These instructions MUST stay with this product.

CONTENTS

1	Explanation of symbols and safety instructions	3
2	General information	4
3	Intended use	5
4	Specifications	5
5	Pre-Installation	6
6	Installing electric kits	9
7	Installing the awning	10
8	Verifying the installation	16

1 EXPLANATION OF SYMBOLS AND SAFETY INSTRUCTIONS

This manual has safety information and instructions to help you eliminate or reduce the risk of accidents and injuries.

1.1 Recognize safety information



This is the safety alert symbol. It is used to alert you to potential physical injury hazards. Obey all safety messages that follow this symbol to avoid possible injury or death.

1.2 Understand signal words

A signal word will identify safety messages and property damage messages, and will indicate the degree or level of hazard seriousness.



WARNING indicates a hazardous situation that, if **not** avoided, could result in death or serious injury.



CAUTION indicates a hazardous situation that, if **not** avoided, could result in minor or moderate injury.



NOTICE is used to address practices **not** related to physical injury.



indicates additional information that is **not** related to physical injury.

1.3 Supplemental directives



Read and follow all safety information and instructions to avoid possible injury or death.

Read and understand these instructions before installation of this product.

Incorrect installation of this product can lead to serious injury.

The installation **must** comply with all applicable local or national codes, including the latest edition of the following standards:

U.S.A.

- ANSI/NFPA70, National Electrical Code (NEC)
- ANSI/NFPA 1192, Recreational Vehicles Code

Canada

- CSA C22.1, Parts I & II, Canadian Electrical Code
- CSA Z240 RV Series, Recreational Vehicles

1.4 General safety messages



WARNING Failure to obey the following warnings could result in death or serious injury:

- This product must be installed and serviced by a qualified service technician.
- **IMPACT OR CRUSH HAZARD:**
 - This awning should be installed in a controlled environment (inside). Do **not** install the awning during windy conditions, or when wind is expected. Otherwise, the awning could move unpredictably, become unstable, and could detach, bend, or collapse.
 - Do **not** remove LED rail (if equipped) from awning fabric. Otherwise, awning fabric could separate from awning rail (on RV) and cause the awning to extend quickly, resulting in detaching, bending, or collapsing. Failure to obey this warning could result in death or serious injury.
- **FIRE OR ELECTRICAL SHOCK HAZARD.** Make sure there are no obstacles (wires, pipes, etc.) inside RV walls. Shut OFF gas supply, disconnect 120 VAC power from RV, and disconnect positive (+) 12 VDC terminal from supply battery before drilling or cutting into RV.
- **IMPACT OR PINCH HAZARD.** Do **not** remove straps (wrapped around each arm assembly) until roller tube is secured to front channel, awning fabric is attached to awning rail, and arm assembly is mounted to RV. Arm assemblies are under tension from gas strut. Removing these ties could allow arms to extend quickly and unexpectedly. Failure to obey this warning could result in death or serious injury.

⚠ CAUTION LIFTING HAZARD. Use proper lifting technique and control when lifting the awning. Failure to obey this caution could result in injury.

NOTICE Failure to obey the following notices could damage product or property:

- ALWAYS use sealant on clean parts and surfaces where fasteners enter RV walls. Otherwise, water leakage could occur.
- Install back channels on a flat surface, level, and keep parallel with each other to ensure correct function and appearance.
- This product is for use with 12 VDC only.

2 GENERAL INFORMATION

Included Parts	Quantity
15 Amp Circuit Breaker	1
#14-10 x 1-1/2" Hex Head Screw	8
#6-20 x 7/16" Self-drilling Hex Head Washer Screw	2
Slit Pin	1
Hardware End Covers (# = B for White, # = U for Black):	4
<ul style="list-style-type: none"> • 3316607.002# Front Right • 3316813.000# Back Right • 3316608.002# Front Left • 3316814.000# Back Left 	

Optional Parts*	Reference Number
Door Roller Kit	830304
Back Channel Spacer Kit	3312853.025 (#)
Door Roller Kits (50 Pack)	830304.003

*Available as accessory (not included).

Required Tools
Drill
3/16" Drill Bit; 7/32" Drill Bit (For Steel Mounting)
3/8" Hex Driver (For Drill)
5/8" Drill Bit

3 INTENDED USE

This 9200 Series Power Awning (hereinafter referred to as "Awning") is designed and intended for installation on a Recreational Vehicle (hereinafter referred to as "RV") during or after the RV manufacture. Use these instructions to ensure correct installation and function of the product.

The Product kit is available for order with various components, so while some graphics may show different components, they still illustrate the correct procedure. All components that were not originally ordered can be purchased as an add-on or upgrade.

The manufacturer accepts no liability for damage in the following cases:

- Faulty assembly or connection.
- Damage to the product resulting from mechanical influences and excess voltage.
- Alterations to the product without express permission from the manufacturer.
- Use for purposes other than those described in the operating manual.

Dometic Corporation reserves the right to modify appearances and specifications without notice.

4 SPECIFICATIONS

4.1 Hardware dimensions (back channel)

	8962XX1.4X0#(L)	8962XX2.4X0#(L)	8962XX3.4X0#(L)
A	62 3/4"	66 1/4"	66 1/4"
B	62 1/8"	65 5/8"	65 5/8"
C	60 1/8"	63 5/8"	63 5/8"
D	60 3/4"	64 1/4"	64 1/4"
E	61 1/2"	65"	65"
F		33"	
G		39"	
H		3/8"	
J		1/4"	
K		5/8"	
L		3/4"	
M		1 1/2"	



Wiring harness location may be at the top or bottom of the back channel, depending on the awning model.

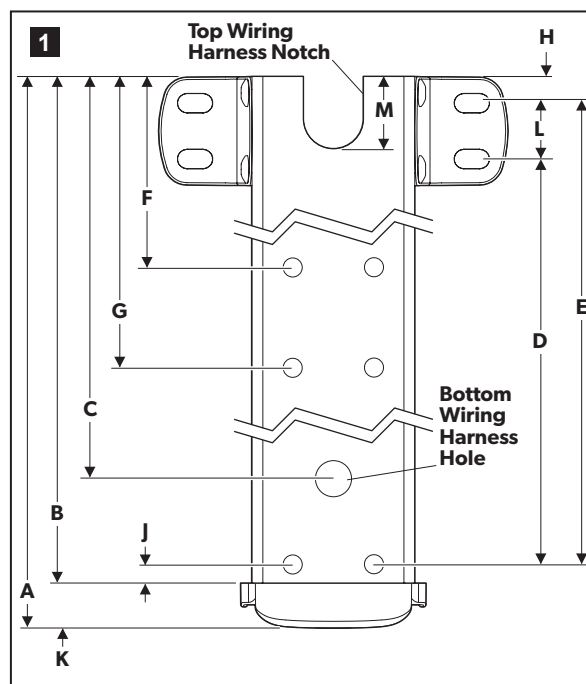

4.2 Door clearance

i When the entry door is toward the center of the awning, add 2" to minimum distances.

Model	Min. Distance (X)
8962XX1.4X0#(L)	12"
8962XX2.4X0#(L)	7"
8962XX3.4X0#(L)	6"

i Doors, windows, lights, trim, slideout rooms, etc. must be considered when determining the length and position of the awning to ensure that the awning will not obstruct them or be affected by them.

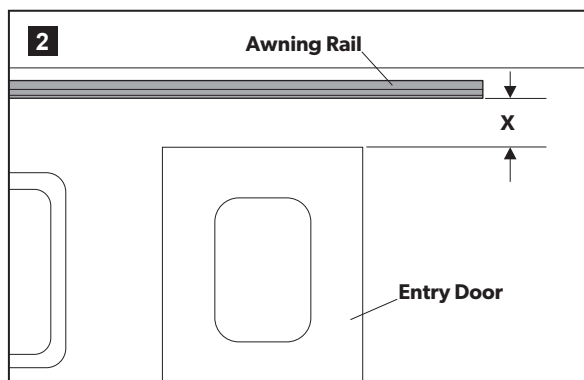

5 PRE-INSTALLATION

5.1 Installing the roller and edge guard (optional)

NOTICE Do **not** allow the corner of the entry door to contact the awning fabric. Otherwise, premature wear or tearing of the awning fabric could occur. If there's potential for a squared corner entry door to contact the awning fabric, a door roller kit (not included) must be installed. Failure to obey this notice could result in damage to the product or property.

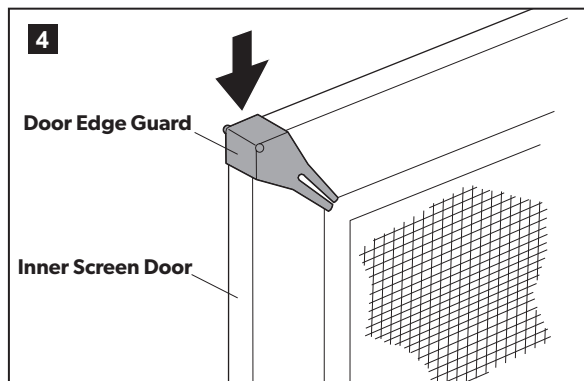
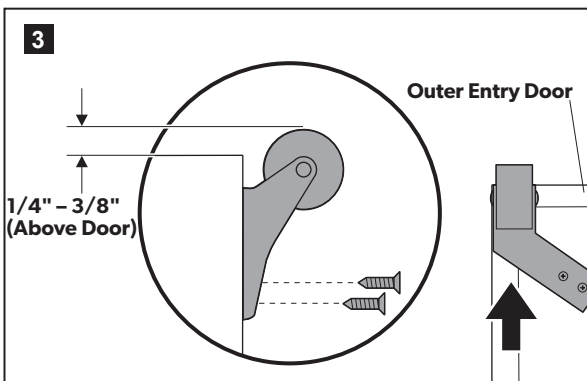

5.2 Preparing the awning rail for fabric insertion

Ensure the awning rail is parallel to the RV floor, and is **not** warped or curved, before installing the awning fabric. If the awning rail is **not** straight, the awning fabric may wrinkle or stretch. Failure to obey this notice could result in damage to the product or property.

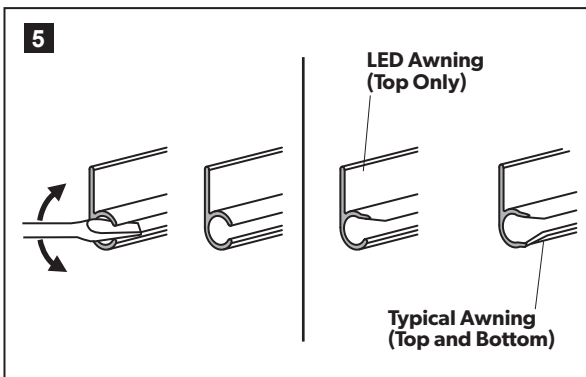

- Select a rail end (on the RV) to insert the awning fabric. Flare (widen) the top and bottom of that end with a flat-bladed screwdriver, and remove (file) any burrs or sharp edges.

i If awning is equipped with LED lights, flare the top of the awning rail end **only**.

5.3 Preparing the awning for installation

i Read before proceeding:

- The motor is already installed on the RH arm assembly.
- The motor and the Slic pin cannot be removed once they are installed.

- Place the fabric roller tube assembly (FRTA) on a protected surface while preparing it for installation.

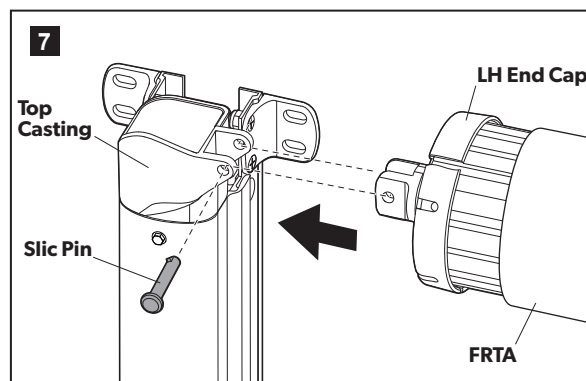
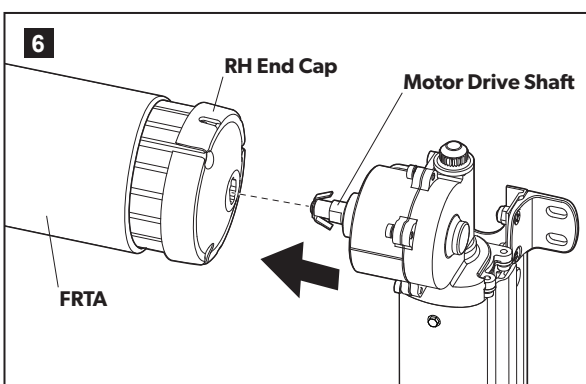

- After motor is installed, pull motor away from Roller tube to verify that it is engaged.

5.4 Determining the awning location

⚠ WARNING IMPACT OR CRUSH HAZARD. Make sure mounting surface on RV is flat, has solid structural backing where fasteners penetrate surface, and will safely and securely support awning. Otherwise, awning may become unstable and could detach. Failure to obey this warning could result in death or serious injury.

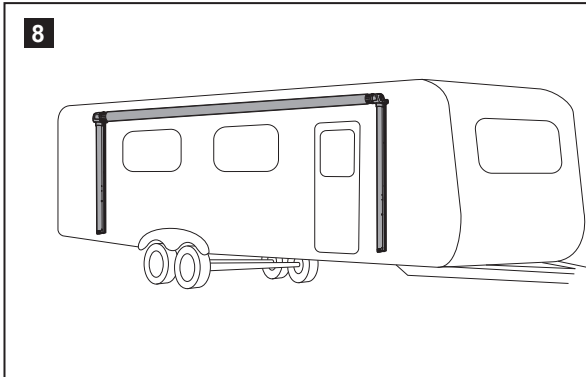

- i** Allow for sufficient clearance between the awning fabric and the entry door, or slideout room, to accommodate awning pitch (slope). Avoid locations that interfere with entry door swing when the awning is completely extended.
- Find a solid structure in the RV wall to support the top mounting brackets and back channels (all mounting points).
- To install over windows, order back channel spacer kit P/N 3312853.025(#).
- i** Make sure arm assemblies do not restrict the use of doors, windows, etc.

6 INSTALLING ELECTRICAL CONNECTIONS

⚠ WARNING ELECTRICAL SHOCK HAZARD. Failure to obey the following warnings could result in death or serious injury:

- Disconnect all electrical connections from the RV.
- Awning must be on a 12 VDC 15 Amp protected, dedicated circuit.

NOTICE Disconnect the positive (+) 12 VDC terminal from the supply battery. Failure to obey this notice could result in damage to the product or property.

- Disconnect power for ALL procedures under this section.

6.1 Installing the awning switch (fixed/wired)

NOTICE Do **not** expose the switch to weather, extreme temperatures, or long hours in direct sunlight. Find a suitable location for awning switch installation. Failure to obey this notice could result in damage to the product or property.



Read before proceeding:

- Use the correct (Dometic Corporation approved) momentary switch, or an electronic control switch with motor overload protection.
 - See instructions included with your Dometic Corporation switch kit for additional wiring instructions.
- Install the 15 Amp circuit breaker (included) at the fuse panel for positive (+) 12 VDC power supply (RED wire) to switch. Otherwise, damage to the awning could occur.
- Route wiring (inside RV) to a general location where connections to the awning hardware will be made. Allow enough wiring length to pass through the outside RV wall (hole will be drilled later) for connection to the awning.
- The wiring hole location will be either at the top or the bottom of the RH back channel, depending on the awning model.
- Make the appropriate wiring connections inside RV. Wiring connections to the awning (through outside RV wall) will be made later.

6.2 Installing the ignition/safety interlock system

⚠ WARNING IMPACT OR CRUSH HAZARD. Do **not** install the awning without also installing an ignition/safety interlock system. Otherwise, accidental operation during transit could occur. Failure to obey this warning could result in death or serious injury.

NOTICE Install a (3 A) fuse (installer supplied) at the fuse panel for positive (+) 12 VDC ignition control (PINK wire) to ignition interlock. Failure to obey this notice could result in damage to the product or property.



Read before proceeding:

- Ignition/safety interlock system is only applicable to motorhomes.
 - The ignition interlock **MUST** break the circuit (cut power) to the awning when the ignition is ON.
- Make the appropriate wiring connections. See instructions included with your Dometic Corporation ignition interlock kit for additional wiring instructions.

6.3 Installing the led light switch (if applicable)

NOTICE Do **not** expose the switch to weather, extreme temperatures, or long hours in direct sunlight. Failure to obey this notice could result in damage to the product or property.

i An LED light switch (installer supplied) is required for awning models equipped with an LED light strip.

- Find a suitable location for LED switch installation.
- Install a (3 A) fuse or a (3A) in-line fuse (installer supplied) at the fuse panel for positive (+) 12 VDC power supply (RED wire) to switch. Otherwise, damage to the awning could occur.
- Route wiring (inside the RV) to a general location where connections to the awning hardware will be made. Allow enough wiring length to pass through the outside RV wall (hole will be drilled later) for connection to the awning.
- Wiring hole location will be either at the top or the bottom of the RH back channel, depending on the awning model.
- Make appropriate wiring connections inside the RV. See instructions included with your LED light switch for specific wiring instructions.

i Wiring connections to the awning (through the outside RV wall) will be made later.

7 INSTALLING THE AWNING

7.1 Inserting the awning fabric into the awning rail

NOTICE Keep both arm assemblies parallel to each other to avoid twisting and damaging the awning. Failure to obey this notice could result in damage to the product or property.

i You will need at least two other people to hold and control the hardware until top mounting brackets and back channels are correctly installed. You may also need a stepladder.

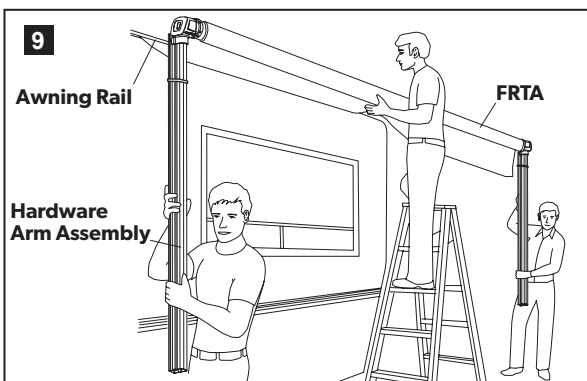

- While one person guides the awning fabric (with awning roller cover, if equipped) into the awning rail, carefully move (carry) the awning hardware assembly to its desired location.
- With one person grasping each arm assembly, carefully lift the entire awning assembly upright. Then carry the awning toward the prepared (flared) awning rail end.

i If an LED light strip is **not** desired, standard fabric **MUST** be used. Otherwise, you may remove the LED light strip from the LED rail, and leave the empty LED rail on fabric rope.

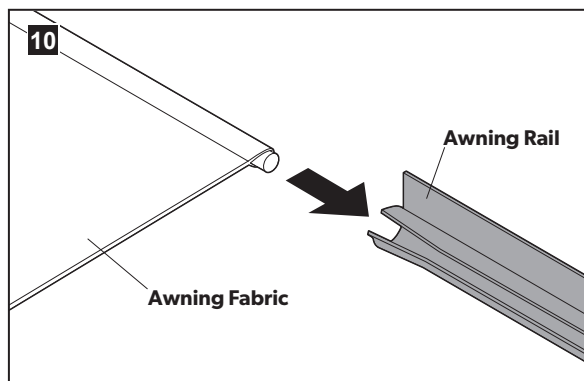

- Unfurl the awning fabric one revolution before inserting the fabric (with the awning roller cover, if equipped) into the awning rail. Unfurling one revolution will allow enough space between the RV wall and the awning hardware to guide the awning fabric into the awning rail.
- Slide the awning fabric into the awning rail while carrying the awning toward the other (non-flared) end.

7.2 Attaching the top mounting brackets

⚠ WARNING IMPACT OR PINCH HAZARD. Arm assemblies are under tension from gas struts. Hold arm assemblies and FRTA securely BEFORE removing ties. Otherwise, arms will extend quickly and unexpectedly. Failure to obey this warning could result in death or serious injury.

NOTICE Control both arm assemblies while installing brackets. When the weight of the FRTA is **not** supported, downward force could cause arm assemblies to swing sideways and damage the RV. Failure to obey this notice could result in damage to the product or property.

i The motorized arm assembly is ALWAYS installed at the RH side of awning.

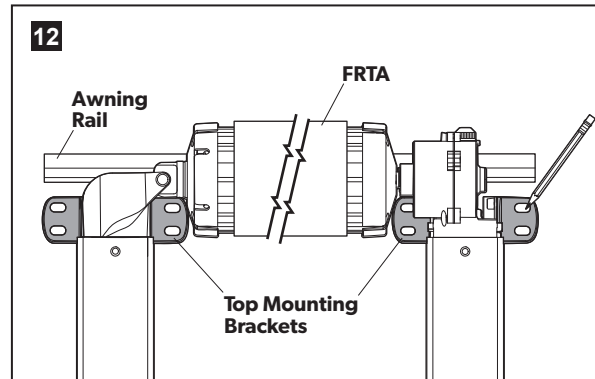
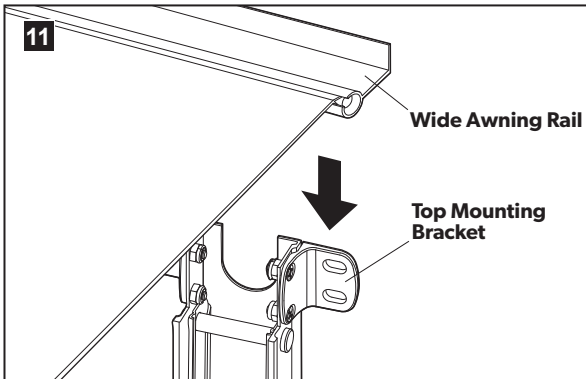

i Some awning rails have a wide drip channel to catch water as it runs off the RV roof. It may be necessary to lower the position of the top mounting brackets to avoid interference.

➤ While holding the arm assemblies securely in place and perpendicular to the awning rail, mark the top set of the mounting hole locations.

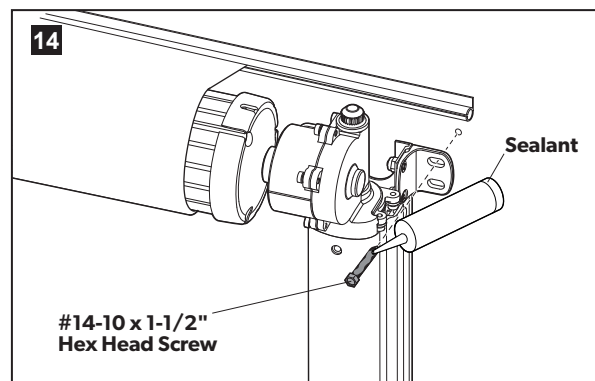
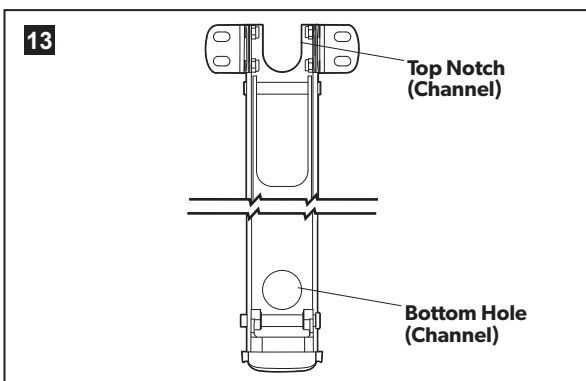

➤ Drill 3/16" diameter holes through the marked mounting hole locations and into the solid structure of the RV. (Drill 7/32" diameter holes if drilling through steel.)

i The wiring harness hole location is determined by awning model. The back channel will either have a notch at top, or a hole near the bottom for wiring to pass through the RV wall.

➤ If the wiring hole location is the bottom of the RH bracket, then skip this step. If the wiring hole location is at the top of the RH bracket, mark the location and drill a 5/8" diameter hole.

➤ Apply sealant to the threads on two #14-10 x 1-1/2" screws.
➤ Place and tighten one screw through the upper outside slot of the RH top mounting bracket and into the solid structure of the RV.
➤ Repeat on the LH side.

i Ensure the arm assemblies are completely closed before tightening the outside screws. Closed arm assemblies will help in the overall alignment of the awning.

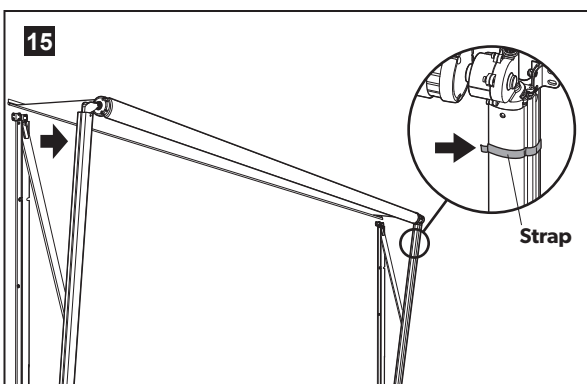

- Remove the straps from the hardware arms and slowly unfurl the awning 12" – 18".
- Apply sealant to the threads on two #14-10 x 1-1/2" screws.
- Place and tighten one screw through the inside upper slot of the RH top mounting bracket and into the solid structure of the RV.
- Repeat on the LH side.

7.3 Attaching the back channels

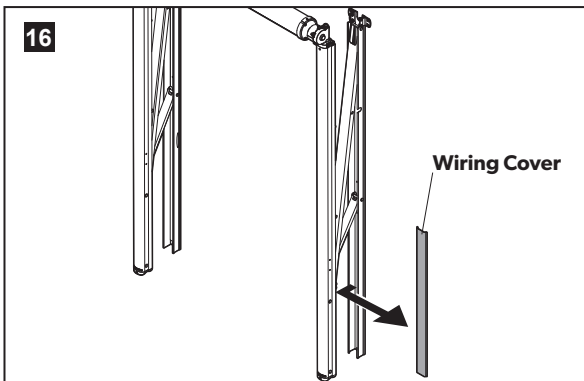

- Remove the wiring cover from the RH back channel (if applicable).

i Set aside the wiring cover for reinstallation later.

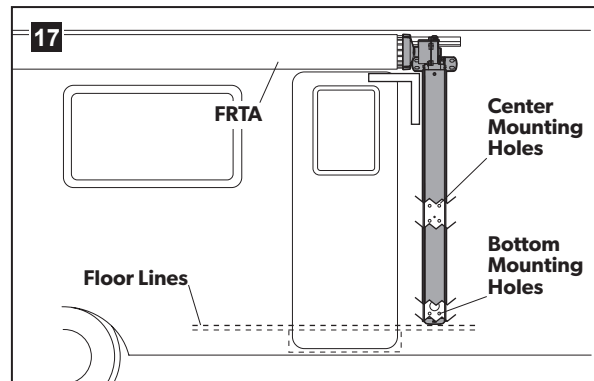

- Square the RH back channel to the RV and the FRTA. Then mark the mounting hole locations. Repeat on the LH side.

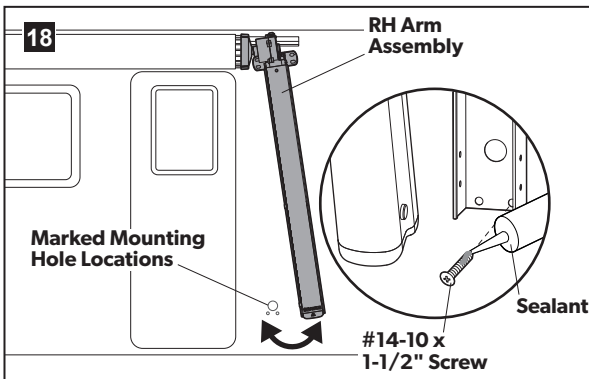

- Swing the RH assembly out of the way to expose the marked hole locations. If necessary, loosen the inside screw of the top mounting bracket.
- Drill $\frac{3}{16}$ " diameter holes ($\frac{7}{32}$ " diameter holes if drilling into steel) through the marked mounting hole locations.
- If you are attaching the LH back channel, or if the wiring will pass through the RV wall at the TOP of the RH back channel, then skip this step. Drill a $\frac{5}{8}$ " diameter hole at the marked BOTTOM wiring hole location and through the outside wall of the RV.

i Swing the back channel back into place. Retighten the screw on the top mounting bracket, if necessary.

- Apply sealant to the #14-10 x 1-1/2" screws (oscar rivets are an acceptable alternative). Place the screws through the bottom mounting holes of the back channel, and secure to the RV.

i Structural backing (with skin) MUST be $\frac{3}{8}$ " to $\frac{1}{2}$ " thick to accommodate the screws. Use structural screws to secure the back channel if the RV has structural backing that supports at least 100 lb. of force per screw.

- Repeat these steps for the LH arm assembly.

7.4 Making electrical connections to the awning

NOTICE Failure to obey the following notices could damage the awning or other property:

- Make sure the positive (+) 12 VDC terminal is disconnected from the supply battery. Otherwise, damage to the awning could occur.
- Always seal wiring against weather and moisture where wiring enters the RV wall, roof or floor. Otherwise, water leakage could occur.
- Do **not** pinch wiring or allow wiring to rub against sharp edges. If wiring is damaged, it **MUST** be replaced by a qualified service technician.

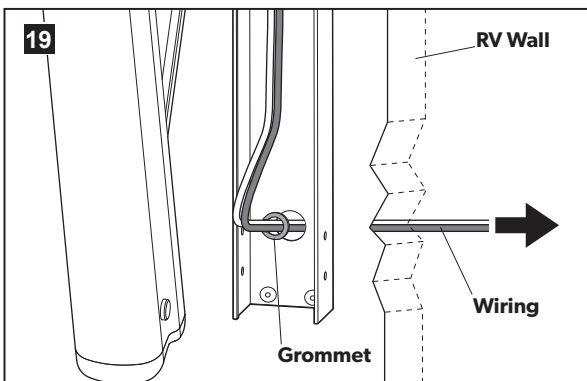

i Use a grommet or heat-shrink tubing where wiring passes through the RV wall. If a grommet is **not** used, make sure sealant will also provide effective and permanent protection against wire damage.

Motor And Switch Connections:

- Plug the motor wire into the motor wire harness at the top of the front arm.
- Pull the wiring through the wiring hole and grommet, and connect to appropriate wiring inside the RV. Make proper electrical connections inside the RV.
- Secure any slack motor/hardware wiring inside the front channel to prevent pinched or damaged wiring during awning operation.

i See instructions included with your Dometic Corporation switch kit for additional wiring instructions.

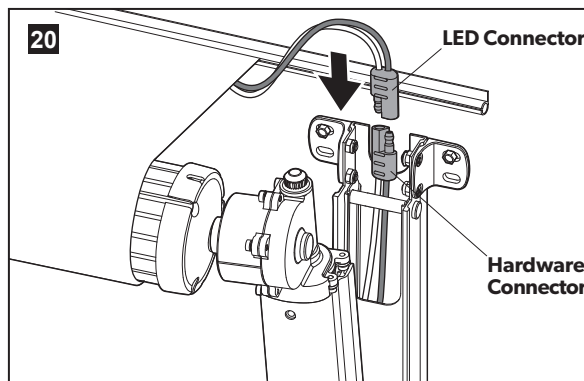

LED Light Connections (If Equipped):

- i** Skip this step if the awning is **not** equipped with an LED light strip.
 - Pull the wiring through the wiring hole and grommet. If a grommet is **not** used, make sure sealant will also provide effective and permanent protection against wire damage.
 - Connect the LED switch wiring to the factory prewired LED light strip.
 - Secure the wiring to prevent pinching or other damage during awning operation. Allow enough slack in the wiring to safely accommodate possible fabric movement.
- i** See instructions included with your LED switch kit (installer supplied) for additional wiring instructions.

7.5 Completing the back channel installation

⚠ CAUTION PINCH HAZARD. Maintain a horizontal distance of at least 16" between the fully open awning and any permanent object. Failure to obey this caution could result in injury.

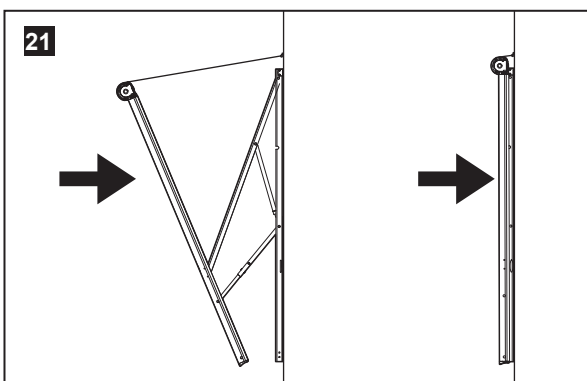

- Restore power and fully retract the awning.
- Verify that the front and back channels are aligning properly.
- Open the awning (fully extend). See "Open Awning" in the Operating Instructions.
- Verify that the back channel is still square with the RV and FRTA.

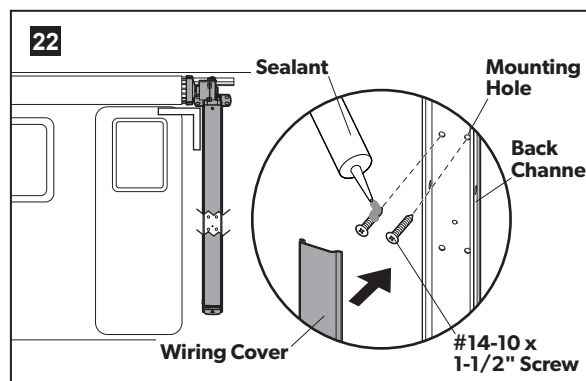

- Disconnect the 120VAC power from the RV and disconnect the positive (+) 12VDC power terminal from the supply battery.
- Using one pair of center mounting holes as a guide, drill 3/16" diameter holes into the solid structure of the RV. Drill 7/32" diameter holes if drilling into steel. The center mounting holes may be above or below the strut.

i The wiring cover (if present) **MUST** be removed from the RH back channel to access the center mounting holes.

- Verify that the wiring is not caught between the hardware and the RV wall before tightening the fasteners.
- Apply sealant to #14-10 x 1-1/2" screws (oscar rivets are an acceptable alternative). Then place the screws through the back channel (center mounting holes) and secure to the solid structure of the RV.
- Structural backing (with skin) **MUST** be 3/8" to 1/2" thick to accommodate the screws.
- Re-install the wiring cover set aside in section "7.3 Attaching the back channels" on page 13.

i Repeat these steps on the LH bracket, then reconnect the power.

7.6 Securing the awning to the railing

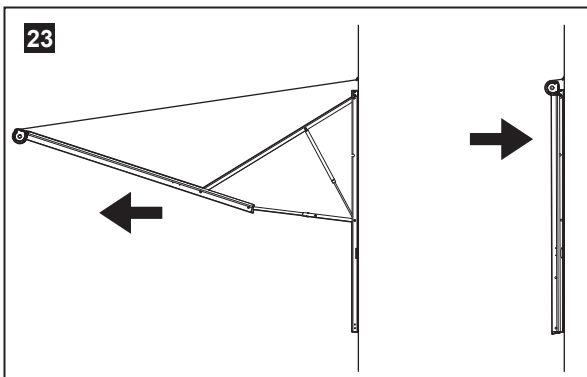

- Open and close the awning 4 – 5 times.
- Verify alignment and hardware nesting. Adjust the hardware if necessary.

i Repeat this procedure as needed.

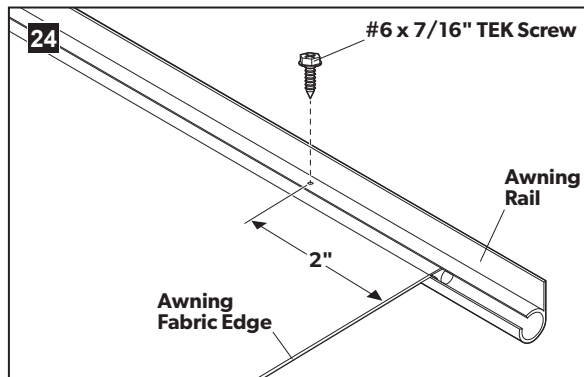

- Pull the right edge of the awning fabric approximately 1/4" beyond its position. Then secure the fabric with one #6 x 7/16" TEK screw through awning rail (approximately 2" from the fabric edge).
- Repeat for the LH side.

7.7 Installing the plastic covers

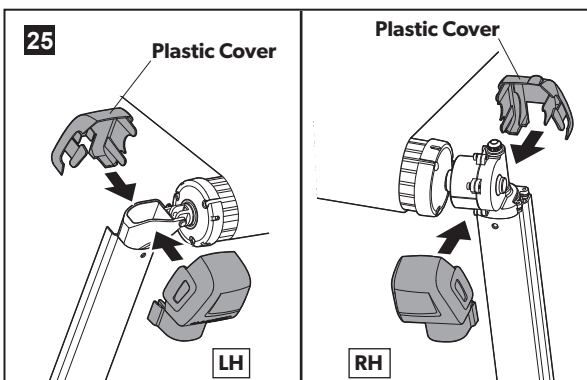

- Snap the plastic covers into position at each end of the awning to complete the installation.

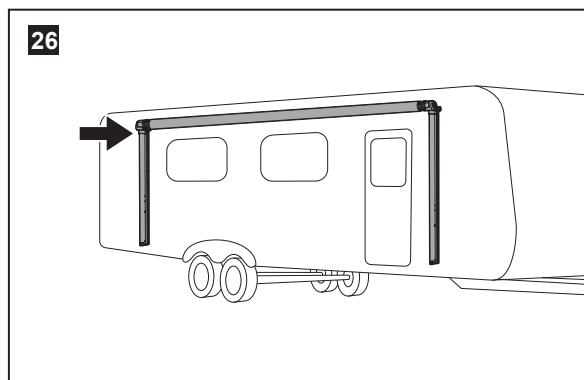

8 VERIFYING THE INSTALLATION

8.1 Testing operation

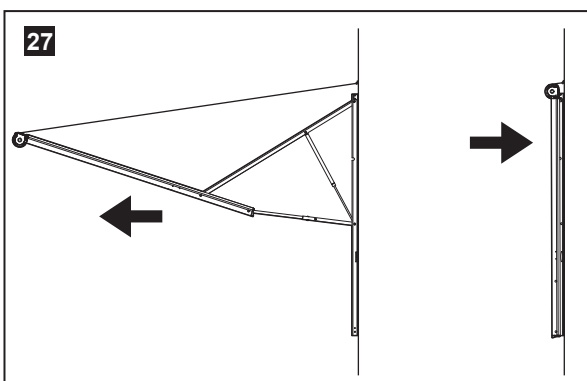

- With power applied to the awning, open and close the awning to verify that each part is functioning correctly.

i Refer to the Operating Manual for securing the awning for travel.

