



TM

GROUND CONTROL GEN III
Owner's Manual

LIPPERT
COMPONENTS™

Table of Contents

Warnings and Basic Jack Operations	3
Dropping from and Connecting to Tow Unit	4
Zero Point Calibration/Error Codes	5
Manual Override Procedures	6-7
Parts Diagram	8
Bill of Materials	9
Wiring Diagram	10
Preventative Maintenance	11

⚠ WARNING

Failure to act in accordance with the following may result in serious personal injury or death. The use of the Ground Control Gen III leveling system to support the unit for any reason other than which it is intended is prohibited by Lippert's limited warranty. The Lippert leveling system is designed as a "leveling" system only and should not be used to provide service for any reason under the coach such as changing tires or servicing the leveling system. Any attempts to change tires or perform other service while unit is supported by the Ground Control Gen III leveling system could result in damage to the 5th wheel and/or cause serious injury or death.

⚠ WARNING

Be sure to park the unit on solid, level ground. Clear all jack landing locations of debris and obstructions. Locations should also be free of depressions. When parking the unit on extremely soft surfaces, utilize load distribution pads under each jack. People and pets should be clear of coach while operating leveling system. Never lift the unit completely off the ground. Lifting the unit so the wheels are not touching the ground will create an unstable and unsafe condition.

BASIC JACK OPERATION

1. Front Landing gear jacks.
2. Rear leveling jacks.

Landing gear jacks can be operated any time the system is "ON" but NOT in the "AUTO MODE." By pushing the "FRONT" button, both front or landing gear jacks can be extended. By pushing either the "LEFT" or "RIGHT" button, the individual front jacks can be extended. If the touch panel is put in the "RETRACT" mode, indicated by the orange illuminated LED next to the "RETRACT" button, the front jacks can be retracted together by pushing the "FRONT" button or individually by pressing either the "LEFT" or "RIGHT" button.

The rear jacks can only be operated when the touch panel is in the "MANUAL MODE." Once system is in "MANUAL MODE," pressing the "REAR" button will extend both rear jacks at the same time. To operate individual rear jacks, press the "LEFT" or "RIGHT" button first, depending on what is needed at the time, then press the "REAR" button and hold both at the same time.

PRIOR TO OPERATION

The leveling system shall only be operated under the following conditions:

1. The unit is parked on a reasonably level surface.
2. Be sure all persons, pets and property are clear of the coach while Lippert Ground Control Gen. III Leveling System is in operation.
3. Make sure battery(ies) are fully charged and load test at 12+VDC.
4. Drop inner leg of both landing gear jacks 4-5 inches.

DROPPING OFF THE UNIT

1. Release the inner legs of both landing gear jacks by pulling on the quick release pins and extending the inner leg 4-5 inches.
2. Push touch panel ON/OFF (Fig. 1A) to turn system on. LCD Screen lights up and displays "READY"(Fig. 1B).

Fig. 1



3. Push the DOWN ARROW to scroll to "DROP FRONT JACKS" option on LCD screen.
NOTE: Orange arrow lights (Fig. 1C) may come on, indicating the current disposition of the unit. In this case the FRONT and RIGHT sides of the unit are low.
4. Push ENTER. Both front landing gear jacks will go to ground and stop.
5. Push the FRONT button extending the front landing gear to a sufficient height, which raises the front of the unit off of the tow vehicle's 5th wheel hitch plate.
6. Pull tow vehicle away and park at a safe distance.
7. Push AUTO LEVEL. The unit will commence to auto level by setting the landing gear jacks close to level. Rear-most jacks will extend to ground, followed by a second ground verification.
8. When auto level is complete, LCD indicates "READY, Jacks: Down" (Fig. 2A) and the green light in the middle of the jack buttons will light (Fig. 2B).

Fig. 2



CONNECTING TO A TOW VEHICLE

1. Press the ON/OFF button to activate the system.
2. Press the LEFT and RIGHT buttons at the same time.
3. The rear leveling jacks will fully retract and then the front landing gears will extend to raise the unit back to the memorized hitch height.

NOTE: The hitch recognition feature will only work if the auto level process was started with the unit in an above level condition.

NOTE: Each time the landing gears are completely retracted, the memorized hitch height will be reset.

ZERO POINT CALIBRATION

1. Manually run the jacks to level the unit. This is best achieved by placing a level in the center of the unit and leveling it both side to side and front to back.
2. Once the unit is level, turn off the touch pad.
3. With the touch pad off, press and release the FRONT BUTTON ten (10) times and then press and release the REAR BUTTON ten (10) times. This will put the system in a zero calibrated state.
4. Press the ENTER button.
5. The system will set this point as its level state.

ERROR DISPLAY IN LCD

1. If an error occurs before or during operation, the error will be displayed in the LCD and a buzzer will sound.
2. The errors that will be displayed are:
 - A. "EXCESS ANGLE" - RELOCATE THE UNIT.
 - B. "BAD CALIBRATION" - BAD ZERO POINT.
 - C. "FEATURE DISABLE" - CYCLE MAIN POWER OR SYSTEM NOT ZERO CALIBRATED.
 - D. "LOW VOLTAGE"
 - E. "OUT OF STROKE" - RELOCATE THE UNIT.
 - F. "EXTERNAL SENSOR" - BAD CONNECTION TO REAR REMOTE SENSOR.
 - G. "JACK TIME OUT"
 - H. "AUTO LEVEL FAILURE" - RETRY.
 - I. "NOT CONFIGURED" - UNIT WAS NOT ZEROED PROPERLY.
 - J. TO CLEAR AN ERROR, MAKE SURE THAT THE JACKS HAVE ALL EXTENDED AT LEAST SIX (6) INCHES, THEN PRESS AND HOLD THE RETRACT BUTTON; ALL JACKS WILL RETRACT AND CLEAR ERROR.
3. Special JACK codes
 - A. LF JACK
 - B. RF JACK
 - C. LR JACK
 - D. RR JACK
 - I. If any of these error codes appear, the system does have manual control over the jacks to prevent being stuck.
 - II. It is important that once the error code has been resolved, the user of the unit must manually retract all jacks completely before exiting the error code. If this step is not completed, the LCD will prompt the user to complete this step as follows:

"ERROR"

"LR JACK"

"MANUALLY RETRACT"

"ALL JACKS"

"PRESS ENTER"

MANUAL OVERRIDE PROCEDURE - TOP OF JACK MOTOR

If manual override is necessary on any jack in the system, there are two options. The following process will describe how to use the top override. See Page 7 for the bottom override.

Tools needed: 3/8" drive ratchet and extension (no socket)

1. Find the port on the top of the jack motor (Fig. 3).
2. Remove the rubber plug (Fig. 3A).
3. Insert the 3/8" drive into the port (Fig. 3B).
4. Turn override until the jack extends or retracts to desired position (Fig. 3C)

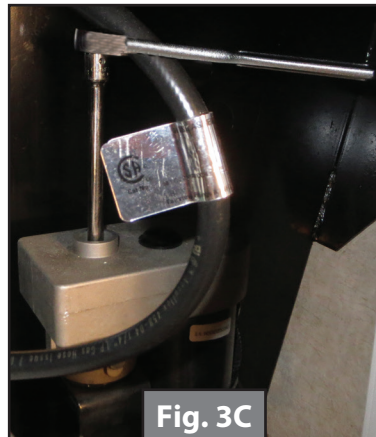
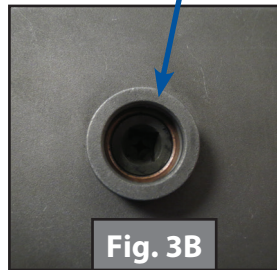
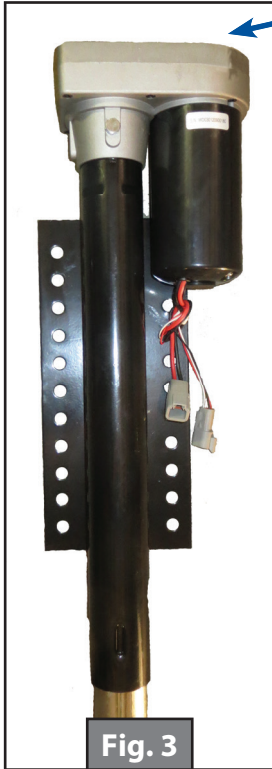

MANUAL OVERRIDE PROCEDURE - BOTTOM OF JACK MOTOR

If manual override is necessary on any jack in the system, there are two options. The following process will describe how to use the bottom override. See Page 6 for the top override.

Tools needed: 3/8" drive ratchet and extension, 5/16" socket

1. Find the port on the bottom of the leveling jack motor (Fig. 4)
2. Remove the rubber plug (Fig. 4A)
3. Place the 5/16" socket onto the override (Fig. 4B)
4. Turn override until the leg extends or retracts to desired position (Fig. 4C)

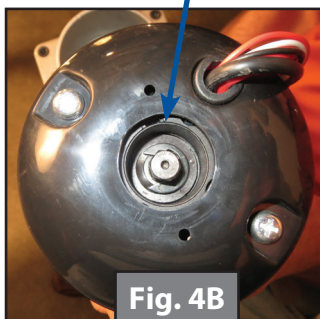
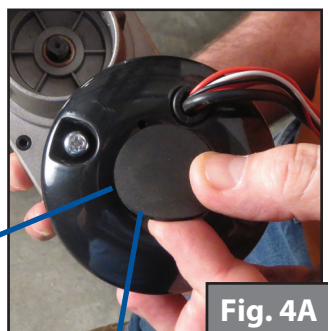
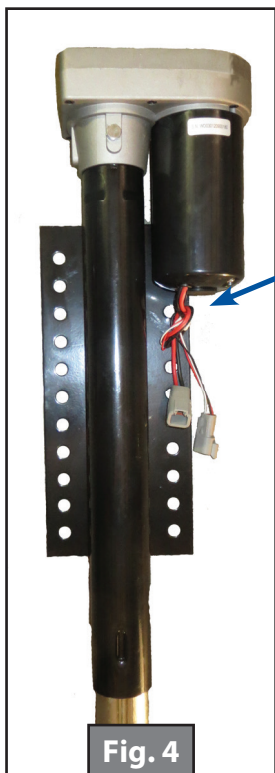



Parts Diagram

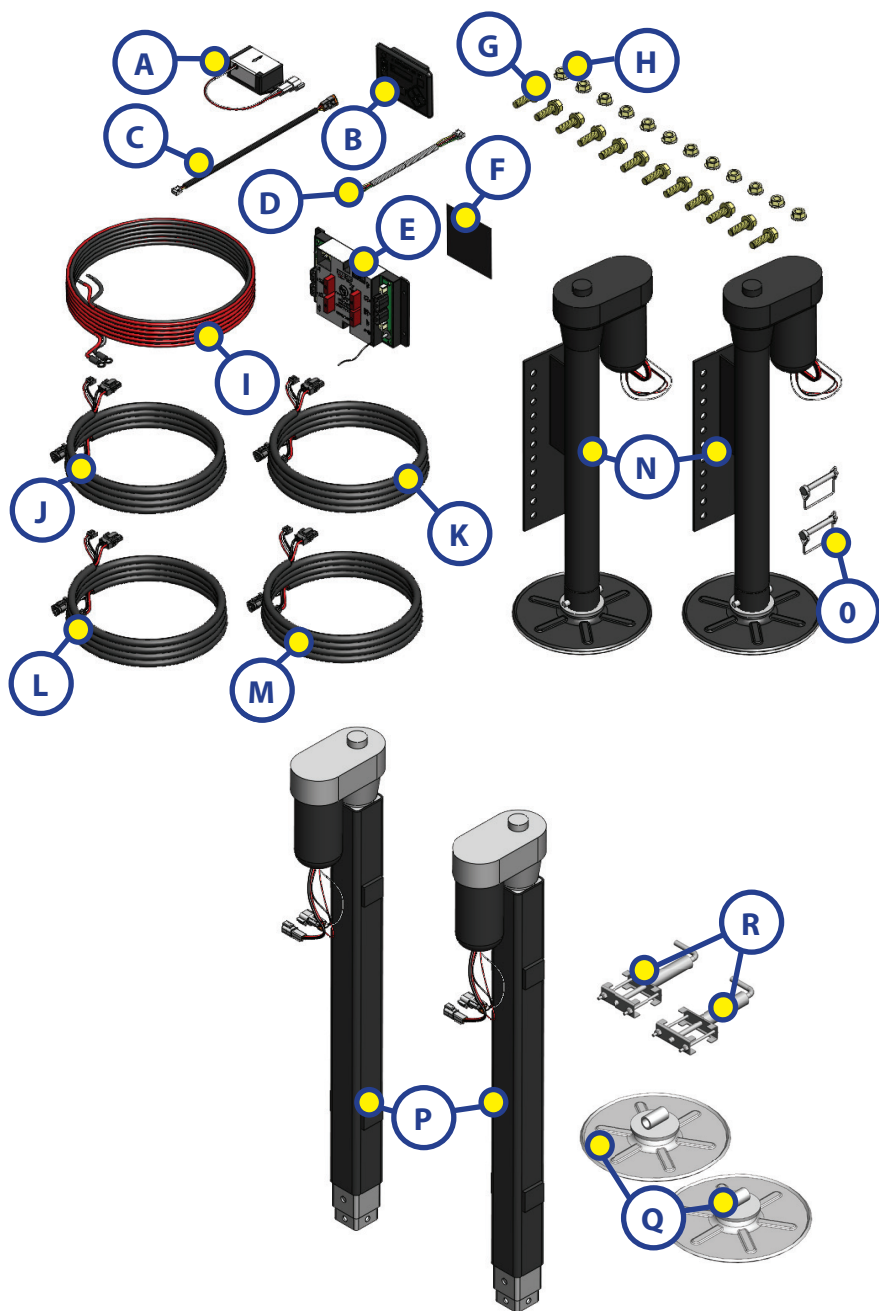

- A.** 232201 - AUTO LEVEL REMOTE REAR SENSOR
- B.** 234802 - LCD INTERFACE PANEL HYDRAULIC 5TH WHEEL
- C.** 243688 - HARNESS BRAIN TO REMOTE REAR SENSOR -35 FT.
- D.** 232937 - BRAIN TO CONTROL BOX HARNESS - 126"
- E.** 304136 - 4 POINT HALL EFFECT CANBUS/WIRELESS GROUND CONTROL MODULE - 17410
- F.** 325810 - 8 1/2 X 6 GROUND CONTROL HALL EFFECT LEVELING LABEL GEN III
- G.** 118076 - BOLT 1/2-20 X 1 1/2 /FLANGE, GR 8 YZN
- H.** 178210 - NUT 1/2-20 UNF/ SERRATED /FLANGE: GRADE 8 YZN
- I.** 306176 - POWER AND GROUND SUPPLY HARNESS FOR HALL EFFECT LEVELING
- J.** 305115 - HALL EFFECT SENSOR REAR HARNESS RIGHT REAR
- K.** 306298 - HALL EFFECT SENSOR REAR HARNESS LEFT REAR
- L.** 307489 - HALL EFFECT SENSOR FRONT HARNESS RIGHT FRONT
- M.** 307490 - HALL EFFECT SENSOR FRONT HARNESS LEFT FRONT
- N.** 305339 - HALL EFFECT JACKS W/ MOUNTING PLATE
- O.** 225598 - PIN, SNAPPER; 3/8 X 3"
- P.** 305340 - HALL EFFECT LANDING GEAR
- Q.** 297788 - LANDING GEAR FOOTPAD
- R.** 119113 - BOLT ON PULL PIN

WIRING DIAGRAM - SEE PARTS LIST ON PAGE 9 FOR REFERENCE

NOTE: *Not supplied by LCI

Wiring Diagram

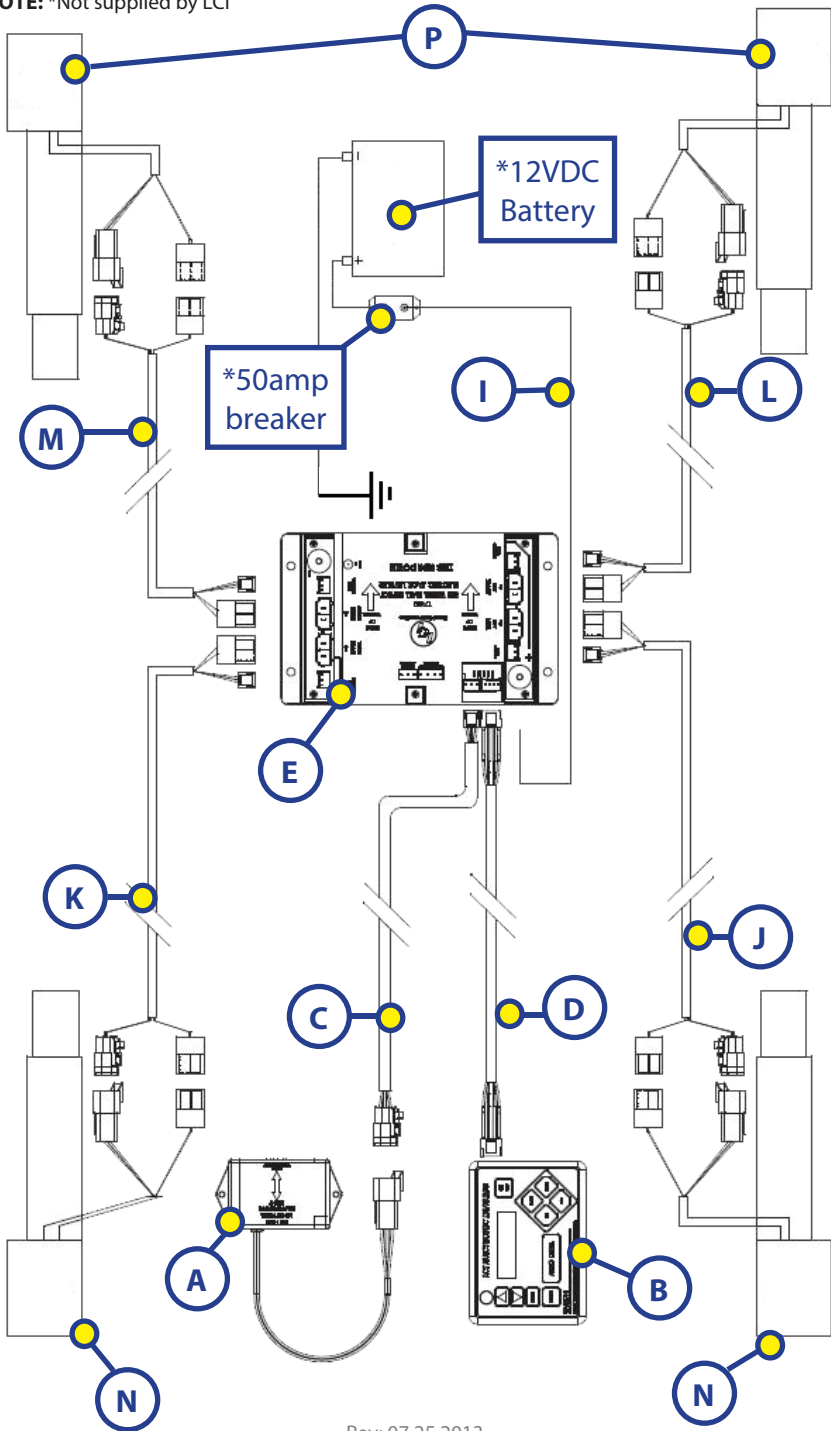

PREVENTIVE MAINTENANCE PROCEDURES

1. Remove dirt and road debris from jacks and stabilizer struts (if equipped) as needed.
2. If jacks are down for extended periods, it is recommended to spray exposed leveling jack tubes with a spray lubricant every 3 months for protection. If the coach is located in a salty environment, it is recommended to spray the rods every month.



Make sure the coach is supported at both the front and rear with jacks stands before working underneath. Failure to do so may result in personal injury or death.



LIPPERT COMPONENTS™

All information contained within may be distributed as a full document only, unless otherwise permitted by explicit consent of Lippert Components Inc. to distribute individual parts.

All information contained within is subject to change without notice. New editions will be posted on www.lci1.com and can be downloaded for free. Information contained within is considered factual until made obsolete by a *NEW* revision.

Please recycle all obsolete materials.

For all concerns or questions, please contact
Lippert Components, Inc.

Ph: (574) 537-8900

Web: www.lci1.com

Email: warranty@lci1.com