

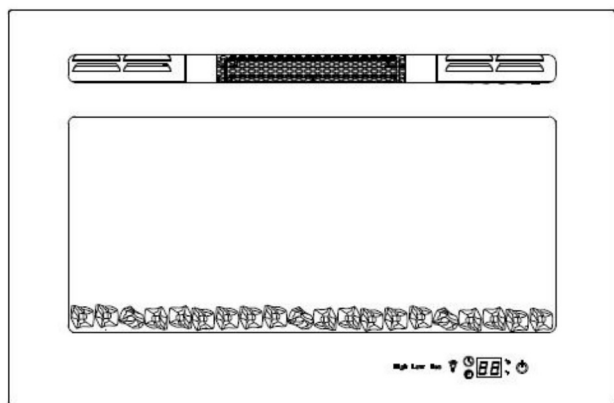

## Full Recessed Electric Fireplace



**WF-26SGPLED**

*This electric fireplace is intended to provide supplemental/comfort heat only and is not meant to be used as a primary heat source when the ambient temperature is lower than 5C/41F.*



### Getting Started

- Remove the appliance from the box.
- Remove any packaging from the product.
- Place the packaging inside the box and either store or dispose of safely.

### Contents of Carton

- Heater
- Remote control
- 4pcs 4x30mm fixed screws
- 1 Instruction Manual

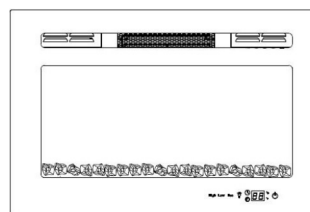

### Helpful Advice before Fitting

- Please retain all packaging until you have checked and counted all the parts and the contents of the hardware pack against the parts list.
- The hardware pack contains small items which should be kept away from young children.
- We suggest that you open the hardware pack and place all the contents into a container, therefore reducing the risk of losing any small pieces.

## Safety

**WARNING:** Improper installation, adjustment, alteration, service or maintenance can cause injury or property damage. Refer to this manual. For assistance or additional information, consult a qualified installer.

**CAUTION:** Do not expose the heater to the elements(such as rain, etc).

**CAUTION:** This unit has automatic thermostat controls. This fireplace can be set to Away from front of heater. Carefully supervise young children when they are in the room with the fireplace.

Fireplace becomes very hot when running. Keep children and adults away from hot surfaces to avoid burns or clothing ignition. Fireplace will remain hot for a time after shutdown. Allow surfaces to cool before touching.

### **WARNING: RISK OF FIRE!**

This unit uses LED bulbs ONLY. If a bulb is dropped or damaged in any way. Return heater to authorized service facility for examination, electrical or mechanical adjustment or repair. 6. Do not use outdoors.

Do not install fireplace on carpet or similar which may restrict air circulation beneath unit.

**Do not place clothing or other flammable material on or near firebox. Never place any objects on the fireplace.**

When using electrical heaters, basic precautions should always be followed to reduce the risk of fire. Electric shock and injury to persons, including the following:

1. Read all instructions before using this heater.

2. This heater is hot when in use. To avoid burns, do not let bare skin touch hot surfaces. The trim around the heater becomes hot while in operation. If provided, use handles when moving this electric fireplace. Although this unit has been tested to zero clearance, to prevent possible fires, do not to partially or fully cover

3 This heater is hot when in use. To avoid burns, do not let bare skin touch hot surfaces. The grills directly in front of heater outlet becomes hot during heater operation.

4. Extreme caution is necessary when any heater is used and whenever heater is left operation and unattended.

5. Do not operate any heater with a damaged cord or plug or if heater malfunctions or has been

6. In order to avoid overheating do not cover the heater.

7. Heater must not be immediately above an electric outlet.

8. This heater is not intended for use in bathrooms, laundry areas and similar indoor locations. Never Locate heater where it may fall into a bathtub or other water container.

9. Do not run cord under carpeting. Do not cover cord with throw rugs, runners or the like. Arrange cord away from traffic area and where it will not be tripped Over.

10. To disconnect heater, turn controls to the OFF position before removing plug from outlet.

11. Do not insert or allow foreign objects to enter any ventilation or exhaust opening as this may cause an Electric shock or fire or damage the heater.

12. To prevent possible fire, do not block air inlets or outlets in any manner. Do not use on soft surface, like a bed, where openings may become blocked.

13. Always use properly grounded fused and polarized outlets. 14. A heater has hot and arcing or sparking parts inside. Do not use it in areas where gasoline, paint or flammable liquids or vapors are used stored.

15. Use this heater only as described in this manual. Any other use not recommended by the manufacturer may cause fire, electric shock or injury to persons.

16. Avoided the use of the extension cord because the extension cord may overheat and cause a risk of fire. However, if you Have to use an extension cord, the cord should be No.16 AWG minimum size and rated not less than 1875 WATTS.

17. Always use grounded fault protection where required by electrical codes.

18. Always disconnect power before performing any cleaning, maintenance or relocation of heater.

19. To prevent a possible fire, do not burn wood or other materials in this heater.

20. To prevent electric shock or fire, always use a certified electrician should new circuits or outlets be required.

21. When transporting or storing heater, keep in a dry place.

22. This unit has automatic thermostat controls. This fireplace can be set to cycle on and off due to ambient room temperature.

23. SAVE THESE INSTRUCTIONS!

- Do not connect the appliance until properly fixed to the wall and the instructions are fully read.
- The minimum distances must be observed in the diagrams.
- For installation of the appliance, care must be taken not to damage concealed cables.
- Please be careful while drilling the holes.

## Wall Insert Instructions

- Take the glass from the appliance first, then gently put the appliance to the cut hole by two persons.  
Please see Fig.1

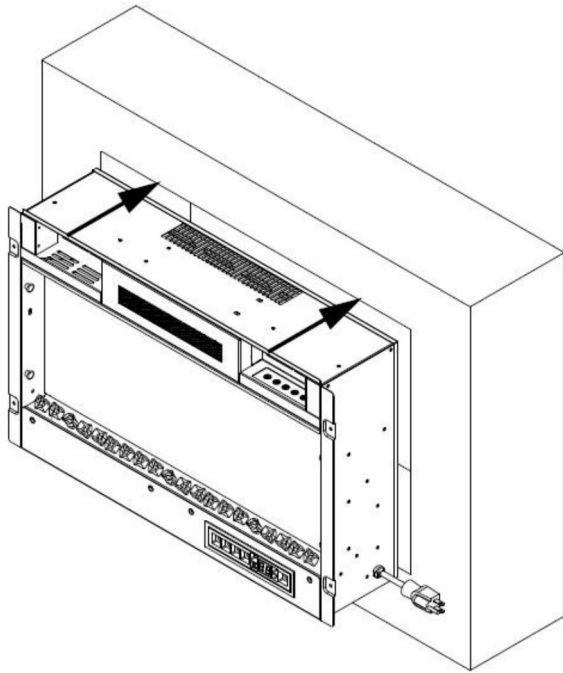

Fig.1

- For optimum viewing, mark the left and right screws ( fixing positions on the wall in accordance with the appliance's holes; See Fig.2

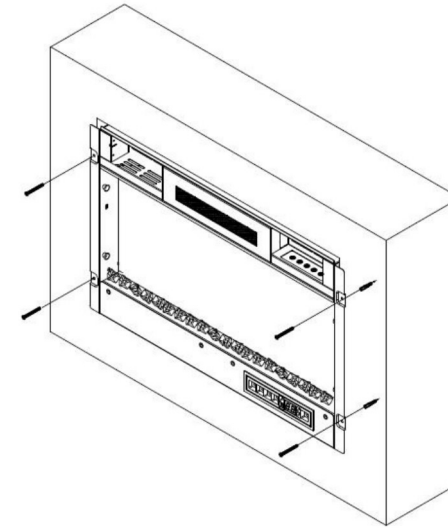

Fig.2

- Place the front glass surround over the front of the fire aligning the slots in the bracket at each side of the glass panel with the lugs on the sides of the fire; See Fig.3
- Again, two people will be required for this operation.

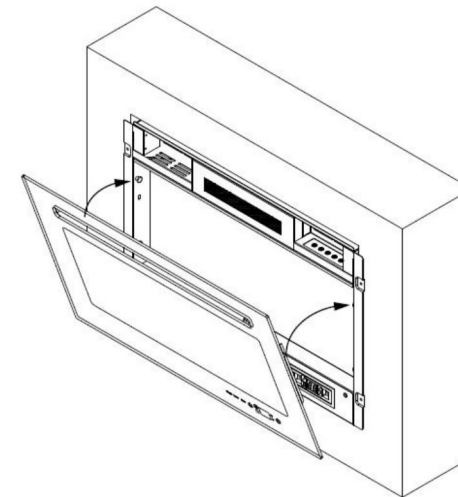
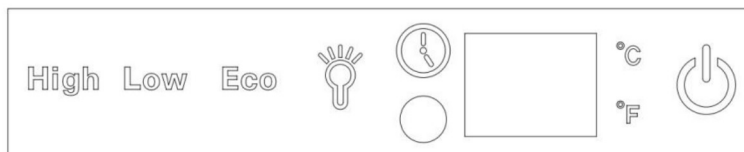

Fig.3

### Display panel



On the WF series fireplaces the display panel will be visible behind the glass in the lower right corner of the fire unit.

### Control panel

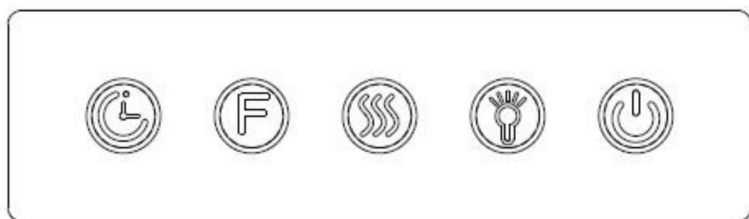

- It takes some time for the receiver to respond to the transmitter. Do not PRESS the buttons more than once within two seconds for correct operation.



-----Power

- Press once the button ON/OFF on the remote control this turns ON/OFF the appliance and fire effect.



-----LED Color

- Press the LED Color button to select from orange, red, or blue.



-----HEAT

- Press once the HEAT button for the low heat setting(750W); press twice for the high heat setting(1500W); press third time to for eco setting; press again to turn off the heating. Press the heat button for three seconds, it will show centigrade degree



-----TERMPERATURE

- Temperature setting. The highest temperature of the thermostat is 82F. There are several thermostat levels can cycle through between 62F to 82F, and the " - " settings. The LED digital display show " --" means OFF settings, the temperature function turn off. Then you can run the heating all the time.



-----TIMER

- Timer setting. Press the TIMER button to cycle through the timer settings (1Hour, 2H, 3H, 4H, 5H, 6H, 7H, and 8H) and the OFF setting.

### Infrared Remote control



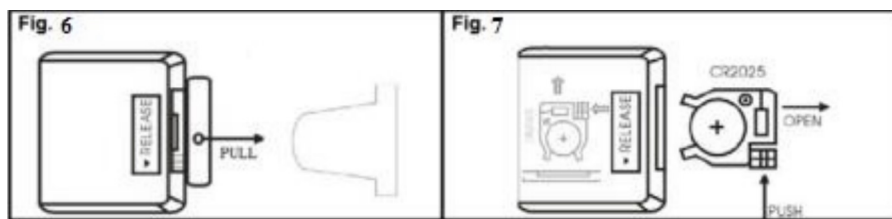

Remote control requires one 3V CR2025 Lithium Cell Battery (included). Remove the protective sheet between the battery and the contacts in order to operate (see Fig 6. and Fig.7).

### REPLACE THE REMOTE CONTROL BATTERY

When the remote control stops operating or its range seems reduced. It is time to replace the battery with a new one.

1. The battery compartment is located on the back end of the remote.
2. Press and slide the battery door open and remove the old battery.
3. Insert a CR2025 battery, checking that the “+” and “-” terminals of the battery matches the inside of the battery compartment.
4. Replace the battery compartment door.

DO NOT mix old and new batteries.

DO NOT use rechargeable silver oxide cell batteries with remote control unit.

DO NOT mix alkaline. Standard (Carbon-zinc). Or rechargeable (Nickel - Cadmium) batteries.

DO NOT dispose of batteries in fire. Improper disposal may cause batteries to leak or explode.

### Important Safety Instructions

When using this electrical appliance, basic precautions should be followed to reduce the risk of fire, electric shock, and injury to person, including the following :

- This heater must be used on an AC supply only and the voltage marked on the heater must correspond to the supply voltage.
- Do not switch the appliance on until it properly installed and described in this manual.
- Do not leave the appliance unattended during use.
- Do not leave the appliance unattended whilst connected to the mains supply.
- Keep out of reach of children and do not allow them to operate this appliance.
- From time to time, check the cord for damage .Never use the appliance if the cord or any part of the appliance shows signs of damage.
- Do not operate this appliance with a damaged plug or cord, after a malfunction or after being dropped or damaged in any way.
- Repairs to electrical appliances should only be performed by a qualified electrician. Improper repairs may place the user at serious risk.
- Do not run the cable under carpets, rugs etc.
- Do not allow the mains cable to hang over sharp edges or come into contact with hot surfaces.
- WARNING: In order to avoid overheating, do not cover or obstruct the heater in any way.
- Overheating will result if it is accidentally covered.
- Never immerse the product in water or any other liquids.

## LED Bulb Replacement

Note: The flame effect on this electric fireplace insert is created by LED Bulbs.

The life of these LED bulbs will be 100,000 hours. The users are not recommended to Replace the LED Bulbs. For any reason should the bulbs stop working properly, contact a Qualified technician.

## Cleaning:

- Turn heater OFF and unplug from electrical outlet before any cleaning or maintenance is performed. Wait at least 10 minutes to allow all components to cool properly.
- Use a vacuum or duster to keep heater and vent area clean from dust and dirt.
- The exterior of the fireplace should be cleaned with a damp cloth or duster. Do not use abrasive cleaners or liquid sprays.



## WARNINGS AND CAUTIONS

- WARNING** To avoid electrical shock not open the back panel of the insert unless the power has been turned off. And the insert has been unplugged.
- WARNING** Any electrical repairs to this electric fireplace. Should only be Performed by a qualified technician.
- WARNING** Any electrical wiring repairs should only be performed by a qualified Technician. And also must comply with local buildings codes.
- WARNING** Discontinue use of this electric fireplace if any of the follow has Occurred: Water damage. If insert has been or dented. If power cord has Become broken. If power cord becomes hot to touch, if unit smokes or Smells like smoke.
- WARNING** This electric fireplace is intended to provide supplemental/comfort heat only and is not meant to be used as a primary heat source when the ambient temperature is lower than 5C/41F.

Note: When the heat functions is used for the first time. A slight odor may be Present. This is normal and should be occur again unless heater is not used For extended periods of time and dust is allowed to accumulate on heater Element.

## Technical Specification

- Supply: 120V/60Hz
- Rated power: 750W/1500W

Meaning of crossed - out wheeled dustbin:

Do not dispose of electrical appliances as unsorted municipal waste, use separate collection facilities.

## Safety Cut-Off

- This appliance is fitted with a safety cut-off which will operate if the fire overheats (e.g. due to blocked air vents) .For safety reasons, the fire will NOT automatically reset.
- To reset the appliance, disconnect the appliance from the mains supply for at least 15 minutes. Reconnect the supply to the mains and switch on the appliance.
- This unit has been tested to zero clearance, to prevent possible fires, do not to partially or fully cover or obstruct

## Troubleshooting

Symptom	Solution
No operation/no fan,	Check fuse by replacement, Check for safety cut-off operation,
No fire effect light,	Check the LED light with technician.



Meaning of crossed –out wheeled dustbin:

Do not dispose of electrical appliances as unsorted municipal waste, use separate collection facilities.

Contact you local government for information regarding the collection systems available.

If electrical appliances are disposed of in landfills or dumps, hazardous substances can leak into the groundwater and get into the food chain, damaging your health and well-being.

**When replacing old appliances with new ones, the retailer is legally obligated to take back your old appliance for disposals at least free of charge.**